

Tel: 01932 351986
Email: info@greenandparry.com



Lane Close, Addlestone, KT15 1SP

Price Guide £315,000



Welcome to the market this three-bedroom split level Maisonette, a leasehold property with a long lease. Offering private rear garden and parking. Well-presented and maintained throughout. Enter the property into a good-sized hallway with downstairs WC and large storage cupboard. The kitchen is modern and a generous size including plenty of wall and base units with ample preparation space. Integrated appliances include electric hob and oven, space available for dishwasher, washing machine and American fridge freezer. This Maisonette comes with a spacious sitting room large enough to accommodate a dining room table. The window and French door from the living space allow plenty of natural light and allow views and direct access out onto the private rear garden. Upstairs is a good size landing space and three very good-sized bedrooms, Master bedroom is a large double, second bedroom is also a good size double room with bedroom three being a large single/small double. The bathroom is modern, fully tiled including bath, shower, WC, hand-basin and modern heated towel rail and built in storage cupboard. This property benefits from a very good sized private rear garden, decked out patio with artificial grass and a brick built shed. Long Lease! Position is good being close to main transport links and a selection of good schools both primary and secondary. VIEWINGS STRICTLY BY APPOINTMENT ONLY!



Floor Plan

Approximate Area = 837 sq ft / 77.76 sq m
For identification only - Not to scale

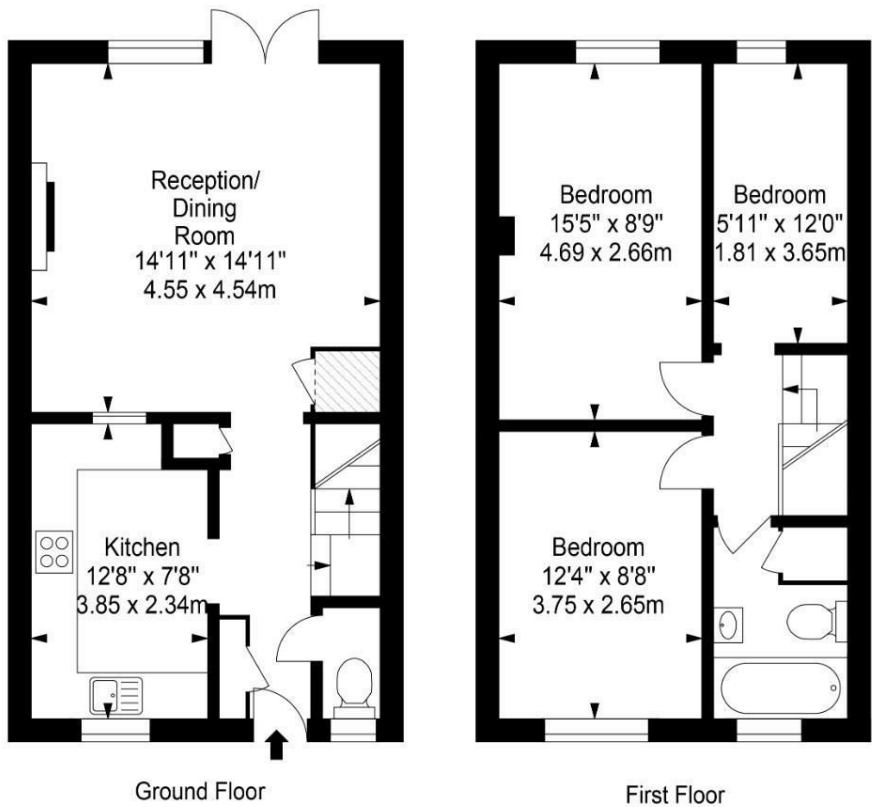

Every attempt is made to assure accuracy, however measurements are approximate and for illustrative purposes only. Not to scale.

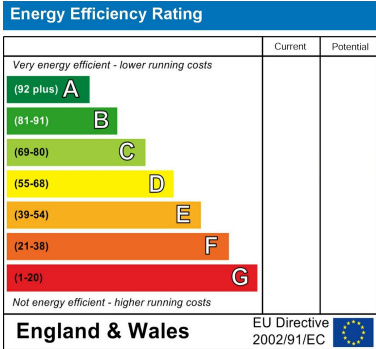

These particulars, whilst believed to be accurate are set out as a general outline only for guidance and do not constitute any part of an offer or contract. Intending purchasers should not rely on them as statements of representation of fact, but must satisfy themselves by inspection or otherwise as to their accuracy. No person in this firms employment has the authority to make or give any representation or warranty in respect of the property.